

Indy-22 Quick Guide



▶ Default IP, Username and Password

- Default IP address: 192.168.1.13 or 192.168.0.13 (vary with firmware version)
- Default username: admin
- Default password: 123456



The default password is used for your first login. To ensure account security, please change the password after your first login. You are recommended to set a strong password (no less than eight characters).

▶ Appearance

Dimensions

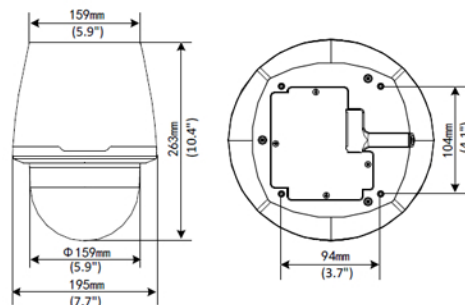

Cable Connection

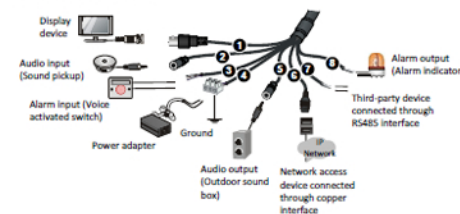

No.	Interface	Function
1	VIDEO OUT	Video output interface. Connect to analog devices such as monitors for video display.
2	AUDIO IN	Audio input interface. Input audio signals or performs intercom. Note: This interface can be used in either audio input or intercom.
3	ALARM IN	Alarm input interface. Input alarm signals.
4	Power interface	Connect the power adaptor.
5	AUDIO OUT	Output audio signals.
6	Ethernet interface	100M/1000M Base-TX adaptive Ethernet interface. Connect to the network.
7	RS485	Interact and control an external device. For example, it can control a third-party device.
8	ALARM OUT	Output alarm signals.

Waterproof Components for an RJ45 Plug

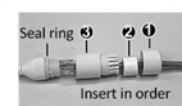

Attach the seal ring to the Ethernet interface. Mount the waterproof components in order. Then insert the cable into the Ethernet interface and screw the waterproof bolt in.

Waterproof Tail Cable

Connect the tail cables and then take the following steps to protect the tail cables from water using waterproof tapes. The figures are for your reference only.



1. Connect the tail cables, and protect the cables and cable connections using insulating tapes. Then wrap all the tail cables together using insulating tapes.



2. Choose a start point for waterproof tapes and protect the tail cables using waterproof tapes.



You can crimp the inner wires of the cable with the RJ45 plug first and then cover the waterproof components. You may also cover the waterproof components first.

Coax Seal Recommended

▶ AccessYour Camera

Before you begin, check that:

- Your camera is operating properly and connected to the network.
- The PC you are using is installed with Internet Explorer 7.0 or later.

Follow these steps to access your camera through the Web interface:

1. Open your browser, input the IP address of your camera in the address bar and then press **Enter** to open the login page.
2. Enter the username and password and then click **Login**.

Part # - EC-PTZSI-22x
3 year warranty

ENVIRO
cams

866-264-0041

sales@envirocams.com
201 N. Elm St.
Kemp, TX 75143

Not Your Father's IP Cameras

Packing List

- PTZ Dome w/ Complete Pigtail
- Power supply & flush ceiling bracket
- Extra waterproof connector
- Gloves & Safety Catch
- Hardware Baggy - 5 screws, drywall anchors, 5 mount screws
- Quick Guide
- Coax Seal

4. Mount the ceiling bracket by fastening the self-tapping screws through the bracket guide holes to the ceiling.



5. Mount the dome and the adapter bracket. Align the four screws of the adapter bracket with the mount points of the dome, and tighten the screws by using a screwdriver.

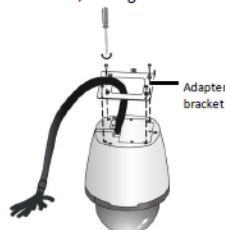

6. Fasten one end of the safety rope to the adapter bracket hole.



7. Fasten the other end of the safety rope to the ceiling bracket, and connect all cables.

- a. Align the four stepped screws of the adapter bracket with the large hardy holes, and push the stepped screws upwards.
- b. Push the stepped screws towards the small hardy holes, verify that the adapter bracket is firmly fixed to the ceiling bracket, and tighten the captive screws.

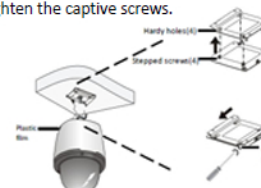

▶ Mount Your Camera Ceiling Mount

1. Locate the positions of the holes. Verify that the holes on the wall align with the inner holes of the ceiling bracket.
 - a. Lead the cable through the hole on the wall.
 - b. Mark the holes by referring to mount points of the ceiling bracket.

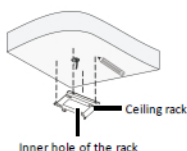

2. Drill holes (depth: about 30 mm) on the wall by using a drill bit of the diameter 6 mm or 6.5 mm.



3. Mount the plastic rivets of self-tapping screws, knock the plastic rivets into the guide holes and ensure that they are tightened up.

