

N-Range Quick Guide



Default IP, Username and Password

- Default IP address: 192.168.1.13 or 192.168.0.13 (vary with firmware version)
- Default username: admin
- Default password: 123456



The default password is used for your first login. To ensure account security, please change the password after your first login. You are recommended to set a strong password (no less than eight characters).

Appearance

Dimensions

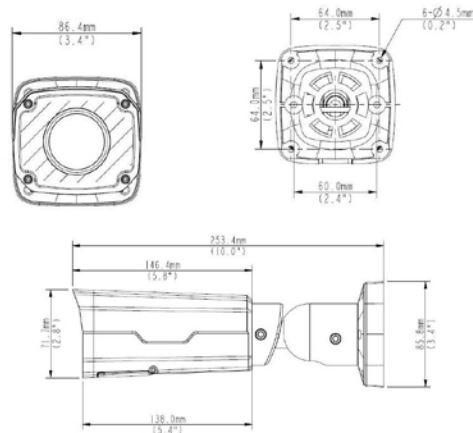

Mount Your Camera

(Optional) Insert the Micro SD Card

For cameras that support Micro SD, you need to insert the Micro SD card after opening the bottom cover of camera. Do not hot plug the Micro SD card after it is inserted. Otherwise the camera or the SD card might be damaged.

For recommended SD card specifications, contact your dealer.

1. Loosen the cross-recessed screws to open the bottom cover.
2. Insert the Micro SD card.



Install Camera

1. Locate the positions of the holes.

1. Paste the installation positioning sticker on the wall and align the cross center to the hole on the wall.

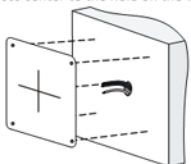

2. Lead the cables across the hole on the wall.

2. Drill holes on the wall.

Use a Ø6-6.5 mm drill bit to drill 30 mm-depth guide holes according to the positions marked by the sticker.

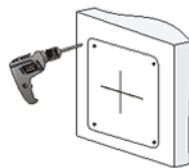

3. Mount the plastic anchors of self-tapping screws.

Knock the plastic anchors into the guide holes and ensure that they are tightened up.

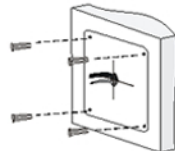

4. Loosen the hex fillister-head screw using a 4# hex L-key (that should be purchased separately) to avoid damaging the universal joint.

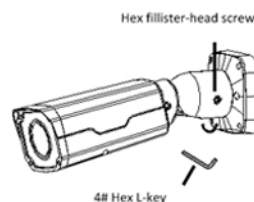

Cable Connection

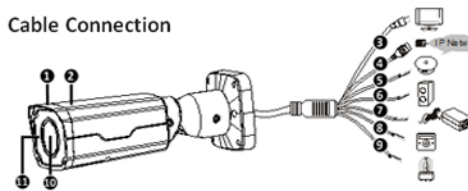

No.	Description	No.	Description
1	Sun shield	2	Housing
3	Video output, BNC interface	4	10M/100M Base-TX adaptive Ethernet interface, RJ45
5	Audio input	6	Audio output
7	Power interface (12 VDC)	8	Alarm input
9	Alarm output	10	Lens
11	IR LED	-	-

Access Your Camera

Before you begin, check that:

- Your camera is operating properly and connected to the network.
- The PC you are using is installed with Internet Explorer 7.0 or later.

Follow these steps to access your camera through the Web interface:

1. Open your browser, input the IP address of your camera in the address bar and then press **Enter** to open the login page.
2. Enter the username and password and then click **Login**.

5. Mount your camera onto the wall and connect all cables.

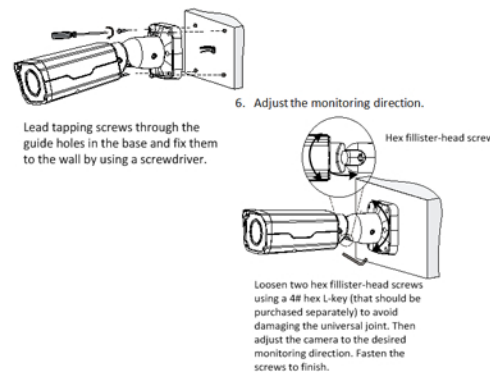

Lead tapping screws through the guide holes in the base and fix them to the wall by using a screwdriver.

6. Adjust the monitoring direction.

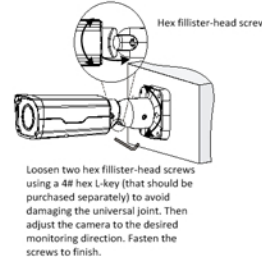

Loosen two hex fillister-head screws using a 4# hex L-key (that should be purchased separately) to avoid damaging the universal joint. Then adjust the camera to the desired monitoring direction. Fasten the screws to finish.

Packing List

- Bullet w/ Pigtail for IP and secondary 12V DC power input
- Extra waterproof connector
- Allen Wrench
- Hardware Baggy - 4 screws and drywall anchors
- Quick Guide
- Coax Seal

Waterproof Components for an RJ45 Plug

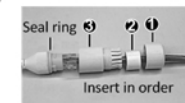

Attach the seal ring to the Ethernet interface. Mount the waterproof components in order. Then insert the cable into the Ethernet interface and screw the waterproof bolt in.

Waterproof Tail Cable

Connect the tail cables and then take the following steps to protect the tail cables from water using waterproof tapes. The figures are for your reference only.



1. Connect the tail cables, and protect the cables and cable connections using insulating tapes. Then wrap all the tail cables together using insulating tapes.



2. Choose a start point for waterproof tapes and protect the tail cables using waterproof tapes.



You can crimp the inner wires of the cable with the RJ45 plug first and then cover the waterproof components. You may also cover the waterproof components first.

Coax Seal Recommended

Part # - EC-IRB2-2812M
3 year warranty

ENVIRO
cams

866-264-0041
sales@envirocams.com

201 N. Elm St.
Kemp, TX 75143

Not Your Father's IP Cameras